

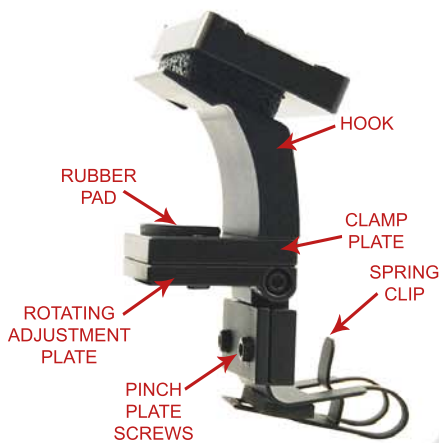

INSTALLATION INSTRUCTIONS FOR THE C6 CORVETTE REAR VIEW MIRROR



1 - Install your radar detector (RD) onto the mount before attaching to the rear view mirror so you can observe how the Spring Clip functions. Squeeze the Spring Clip Release Tab and the back side of the mount together. Push the RD Release button and slide the RD onto the Spring Clip until the RD hits the bottom of the Spring Clip Release Tab. Then release both the Tab and the Button. Now slide the RD just slightly toward you until you hear it lock into position.



2 - Observe the illustration above which identifies the components of the mount. Remove the Spring Clip by removing both Pinch Plate Screws.

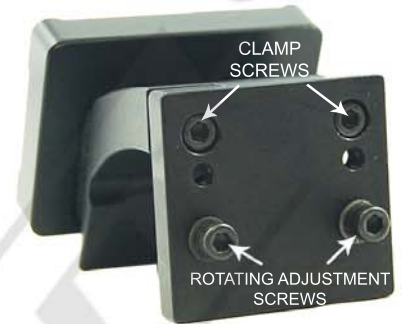

3 - IMPORTANT - Observe the two Clamp Screws that are accessible through the slots of the Rotating Adjustment Plate. Before installing the mount, insert the supplied allen wrench into the heads of the Clamp Screws to make sure they are accessible.



4 - This photo illustrates how the Hook fits into the recessed area behind the mirror. This is just a reference photo as you will not be able to see this during installation.



5 - Place the Windshield Pad onto the Silicone Pad. Position the mount as shown above. Compress the Silicone Pad into the recessed area behind the mirror. You will hear the Hook snap into place when it is positioned correctly as shown in fig. 6.



6 - Tighten the two Clamp Screws (identified in fig. 3), alternating from one to the other every two or three revolutions. You will notice a little resistance once the Rubber Pad starts compressing against the bottom of the mirror. Make sure that both Clamp Screws are tight. Reattach the Spring Clip the Pinch Plate.



7 - Install the RD onto the mount making sure it locks onto the Spring Clip. You should hear it lock into position. Make the necessary adjustments as shown. We recommend adjusting the RD so it is as close to the bottom of the mirror as possible. There may not be enough room for your finger to fit between the RD and the mirror, however the spring clip allows you to move the RD downward with one finger while pressing the RD buttons with another finger. The RD will return to its original position when released. After all adjustments are made, be sure to check that all adjustment screws are tight. Grab the long arm of the allen wrench to assure that these screws are securely tightened.



8 - We recommend installing the 3/4" diameter Support Pad between the mirror and the RD for additional stability. There are three different thicknesses included depending on the gap between the RD and the mirror after all adjustments are made. Use the supplied alcohol pad to clean the top of the RD before installing Support Pad.

CAUTION

DO NOT use this mount if it interferes with the adjustability or the operation of your rear view mirror in any way.

DO NOT use this mount if the radar detector creates an unsafe viewing obstruction.

DO NOT ATTEMPT TO MODIFY THIS PRODUCT. Consult the manufacturer for assistance.

All BlendMount products are accompanied with detailed installation instructions and adjustment tips. You are encouraged to contact customerservice@blendmount.com or call J28 Design at 1-707-664-8234 for further assistance.

Your feedback is very important to us. Please email any questions or comments you have to customerservice@blendmount.com

